

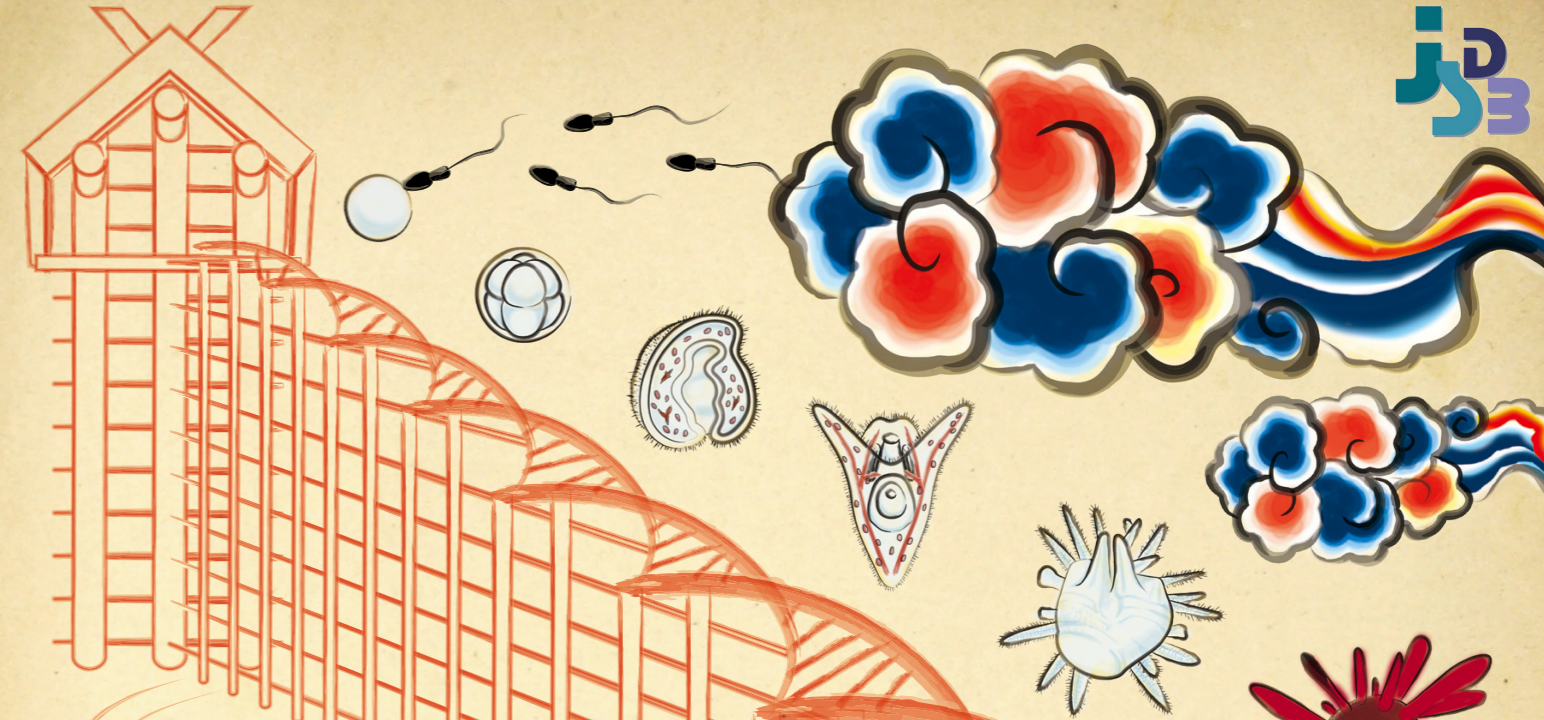

46th Annual Meeting for the Japanese Society of Developmental Biologists Program Book



46th Annual Meeting for the Japanese Society of Developmental Biologists

cosponsor: the Asia-Pacific Developmental Biology Network

第46回日本発生生物学会

May 28-31, 2013/Kunibiki Messe (Matsue-City, Shimane Prefecture)

Chairperson : Takashi Matsuzaki (Shimane Univ.)

Program Book



May 28-31, 2013 Shimane

<http://www.jsdb.jp/kaisai/jsdb2013>

LAVENDER Nitrile Exam Gloves

ラベンダー・ニトリルグローブ

250枚入

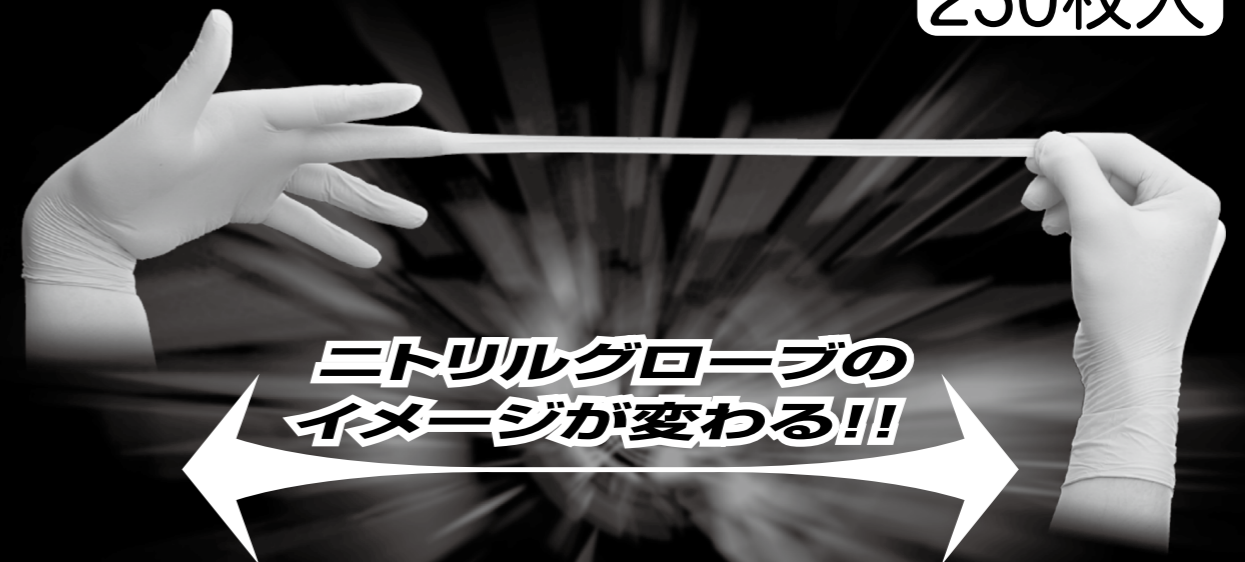

ニトリルグローブの
イメージが変わる!!

250枚入 ゴミ削減・スペース削減

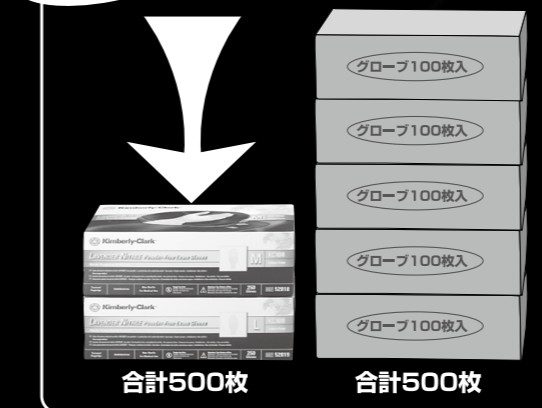

ムレにくさUP!

柔らかさ・フィット感UP!

注文コード	商品 No.	サイズ	入 数	価 格
188151	52816	XS	250枚/箱	¥ 2,900
188152	52817	S	250枚/箱	¥ 2,900
188153	52818	M	250枚/箱	¥ 2,900
188154	52819	L	250枚/箱	¥ 2,900

Registered Trademark or Trademark of Kimberly -Clark Worldwide,Inc. COLOR LAVENDER-Trademark of KCWW. (c) 2006KCWW.All Rights Reserved.120873-01

<http://www.bio-bik.co.jp>

INA・OPTIKA

株式会社 イナ・オプティカ

本 社
〒530-0043 大阪市北区天満2-1-29 (オブテックダイエービル)
TEL: 06-6882-6006 FAX: 06-6882-6116
E-mail: info@bio-bik.co.jp

福岡営業所
TEL: 092-623-8122 FAX: 092-623-8123
長野営業所/信州配送センター
TEL: 0265-86-2434 FAX: 0265-86-5613

Welcome to the 46th Annual meeting of JSDB in Matsue

Dear colleagues,

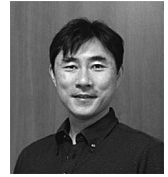

“Get back to the origin”

I am pleased to inform you that the 46th annual meeting for the Japanese Society of Developmental Biologists (JSDB) cosponsored by the Asia-Pacific Developmental Biology Network (APDBN) will be held in Matsue in Shimane prefecture from May 28th to 31st 2013.

Matsue is a compact and relaxing town located at about 600 km west of Tokyo and 150 km Northeast of Hiroshima. You can come to Matsue from Izumo airport or Yonago airport in 40 min, or taking JR line from Okayama.

The venue, KUNIBIKI MESSE is close to Matsue station, and most hotels are around the station, which allows you to reach the venue within 10 min walk from your hotels.

In the meeting, we are planning to provide as much time for discussion as possible. For that, all presentations will be presented both in oral and poster. We have a big space where 400 posters of all presentations could be put for discussion during the whole meeting, which is next to or close to the rooms for oral presentation. You can discuss with data and photos by the poster boards after listening the talks, during lunch and rest, and also in the Banquet.

By listening plenty of talks, including those not directly correlated with your work, and discussing with numerous colleagues, you must obtain lots of unexpected knowledge and novel ideas. For young researchers, one of most basic and substantial skills to be learned is to tell the pivotal points of their studies in a limited period. These used to be main purposes of our society meeting, but it has been difficult to get with poster-oriented presentation style these days. Therefore, we should get back to our initial standpoint once again.

Coincidentally, it is 1,300 years anniversary for publication of KOJIKI, the oldest Japanese book, describing that Shimane region was a central place in incunabula of Japanese history. We believe Matsue is the best place to return to the origin of our society.

Please come to Matsue and enjoy discussing with many smart heads much more than those of YAMATANO-OROCHI, a mythological monster snake with eight heads as shown in our poster of the meeting.

Lastly, do not miss beautiful sunset on Lake Shinji too.

We look forward to seeing you in Matsue.

Takashi Matsuzaki

Chairperson

Organizing Committee of the 46th annual meeting of JSDB 2013

『もう一度原点に戻ろう』

2013年5月28日から31日まで島根県松江市において、第46回日本発生生物学会年会がアジア太平洋発生生物学ネットワークの共催で開催されます。松江市は東京の西方約600km、広島
島の北西150kmに位置するこぢんまりとした落ち着いた街です。松江までは出雲空港からでも米子空港からでも40分ほどで着きますし、岡山からJR線も利用できます。学会会場の“く
にびきメッセ”は松江駅近傍にありますので、駅前のホテルからは会場まで徒歩10分ほどです。

今大会ではできるだけ多く討論時間が取れるようにと考えています。そのため、全演題とも口
演とポスターの両方で発表していただく予定で、口演会場の近くに400演題全てのポスターを
大会期間中ずっと掲示できる大きなスペースを用意します。口演の後、昼食や休息、そして懇
親会の時など、ポスターボードに張られたデータを見ながらいつでもディスカッションしてい
ただけます。

自身の研究と直接関わりが無いような口演やディスカッションもたくさん聞けるので、思っ
てもみなかったような話や斬新なアイデアに出会えるに違いありません。また、限られた時間
の中で自分の研究の要点を伝えられるようになることは、とくに若い研究者が身につけるべき
基本的なスキルです。こうした経験を積むことが昔の学会では当たり前でしたが、近年はポ
スター発表が主流となり難しくなっています。そこで私たちはもう一度原点に立ち帰るべき
だと考えました。

奇遇なことに、今年には日本最古の書物である“古事記”編纂から1,300年に当たります。古事
記には島根地方が日本黎明期の中心の一つであったことが記されていますので、日本発生生物
学会の原点に戻ってみようとするなら、松江こそがもっともふさわしい場所と思います。

是非松江まで足を運び、学会ポスターに描きましたヤマタノオロチの頭数をはるかに凌ぐ多く
の俊英達とのディスカッションをお楽しみください。また、美しい宍道湖の夕日もお忘れなく。
では、皆さんにお会いできるのを楽しみにしています。

大会長 松崎 貴（島根大学生物資源科学部）

目次

ご挨拶	1
スポンサー	5
大会準備委員	5
会場への交通ご案内	6
会場内の見取り図	9
日程表	10
参加者へのご案内	14
DGD 編集委員会・JSDB 運営委員会	15
懇親会	15
ランチョン・セミナー	16
託児所	17
発表についてのご注意	18
iWAB (Web Abstract Book)	20
プログラム	
プレナリー・レクチャー	25
シンポジウム	26
オーラルプレゼンテーション	29
フラッシュトーク	48
若手ワークショップ (日本語)	65
テクニカルワークショップ	69
サテライトシンポジウム	70
ポスターセッション	71
市民公開講座 (日本語)	101
男女共同参画ワークショップ (日本語)	103
Getting Published Well: Strategies for Success	104
発表者氏名索引	105
展示企業一覧	
広告	
WEB 要旨集 閲覧方法	

Contents

Welcome Messages	1
Acknowledgement of Sponsorship	5
Organizing Committee	5
Access Guide to KUNIBIKI MESSE	6
Floor Maps of KUNIBIKI MESSE	9
Program at a Glance	10
General Information for Attendance	14
DGD Editorial Meeting & JSDB Board Meeting	15
Reception	15
Luncheon Seminar	16
Nursery	17
Instructions for Presentations	18
iWAB (Web Abstract Book)	20
Scientific Programs	
Plenary Lectures	25
Symposia	26
Oral Presentations	29
Flash Talks	48
Satellite Workshops (in Japanese)	65
Technical Workshop	69
Satellite Symposium	70
Poster Sessions	71
Public Lectures (in Japanese)	101
Forum by Gender-equal society (in Japanese)	103
Getting Published Well: Strategies for Success	104
Author Index	105
Advertisements	
How to view the online abstract book	

Acknowledgement of Sponsorship

The organizing committee of 46th Annual Meeting for JSDB gratefully acknowledges the generous financial support of the following:

Sponsors

Osaka Pharmaceutical Manufacturers Association
Suntory Institute for Bioorganic Research
The Company of Biologists

Organizing Committee

Chairperson:	
Takashi Matsuzaki	Shimane University
Members:	
Akio Nishikawa	Shimane University
Takashi Takeuchi	Tottori University
Yasuaki Shirayoshi	Tottori University
Hiroyuki Takeda	University of Tokyo
Atsuko Sehora	Kyoto University
Toshihiko Fujimori	National Institute for Basic Biology
Shigeo Hayashi	RIKEN Center for Developmental Biology
Yuji Kageyama	Kobe University
Setsunosuke Ihara	Shimane University
Mikiko Kobayashi-Miura	Shimane University
Noritaka Hirohashi	Shimane University
Toshinori Hayashi	Tottori University

Access Guide to KUNIBIKI MESSE

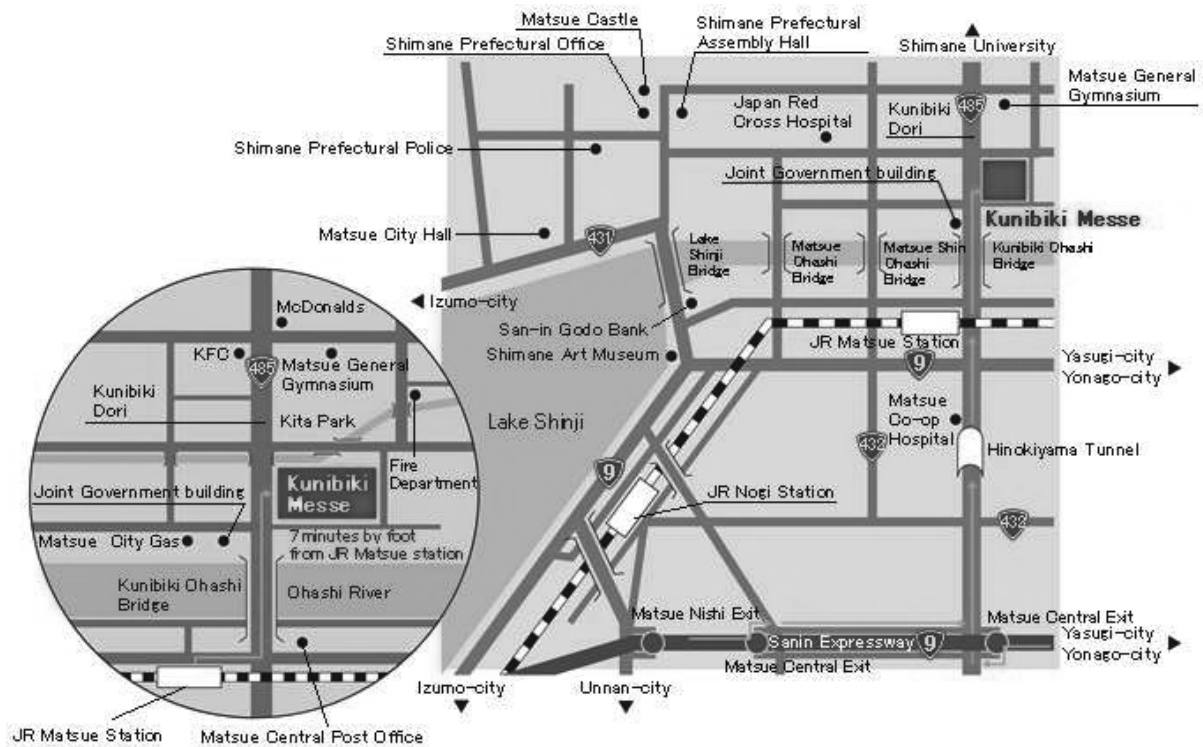
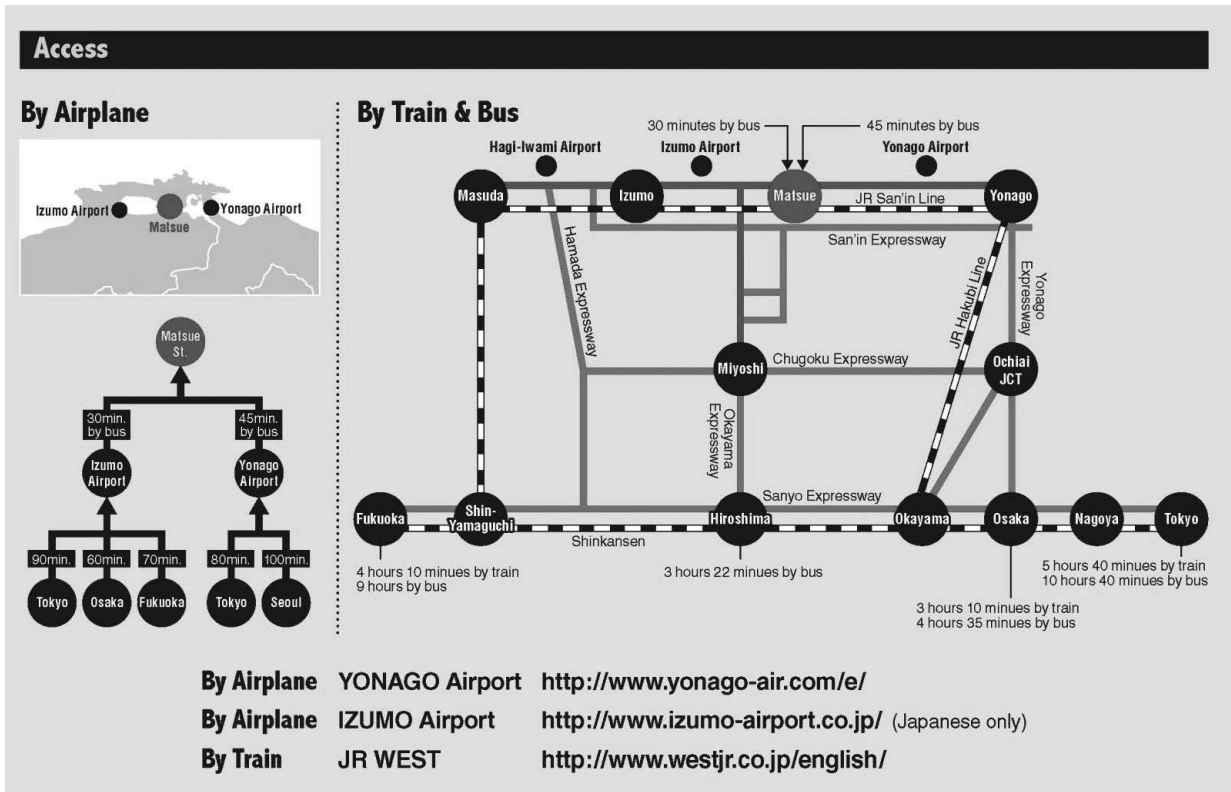

7minutes by foot from JR Matsue Station.

Airlines

There are two airports close to Matsue. One is Izumo Airport (IZO) and the other is Yonago Airport (YGJ). A shuttle bus delegates from these airports to Matsue Station near the conference venue.

Shuttle Bus Timetable

Izumo (IZO) to Matsue

Izumo Airport → JR Matsue Station, Matsue Shinjiko Onsen Station (JP¥1000 or 1100)

Arr. Time	Flight No.	Departure	Izumo Airport	JR Matsue Station	Matsue Shinjiko Onsen Station
8:35	2341	Osaka	8:45	9:15	9:21
9:00	1663	Tokyo	9:10	9:40	9:46
10:50	3551	Fukuoka	11:00	11:30	11:36
11:10	2343	Osaka	11:20	11:50	11:56
12:15	1665	Tokyo	12:25	12:55	13:01
12:20	2347	Osaka	12:30	13:00	13:06
13:05	3434	OkI	13:15	13:45	13:51
15:10	2351	Osaka	15:20	15:50	15:56
15:40	1667	Tokyo	15:50	16:20	16:26
16:45	2355	Osaka	16:55	17:25	17:31
17:30	1669	Tokyo	17:40	18:10	18:16
18:15	2357	Osaka	18:25	18:55	19:01
18:40	3557	Fukuoka	18:50	19:20	19:26
19:55	1671	Tokyo	20:05	20:35	20:41

JR Matsue Station, Matsue Shinjiko Onsen Station → Izumo Airport (JP¥1000 or 1100)

Matsue Shinjiko Onsen Station	JR Matsue Station	Izumo Airport	Depart. Time	Flight No.	Destination
6:20	6:30	7:00	7:50	1662	Tokyo
7:30	7:40	8:10	9:00	2342	Osaka
8:10	8:20	8:50	9:40	1664	Tokyo
9:45	9:55	10:25	11:15	3550	Fukuoka
10:05	10:15	10:45	11:35	3433	OkI
11:15	11:25	11:55	12:45	2346	Osaka
11:30	11:40	12:10	13:00	1666	Tokyo
12:15	12:25	12:55	13:45	2350	Osaka
14:05	14:15	14:45	15:35	2354	Osaka
15:05	15:15	15:45	16:35	1668	Tokyo
15:40	15:50	16:20	17:10	3558	Fukuoka
16:45	16:55	17:25	18:15	1672	Tokyo
17:10	17:20	17:50	18:40	2356	Osaka
17:35	17:45	18:15	19:05	2358	Osaka

Yonago (YGJ) to Matsue

Yonago Airport → Matsue Station (JP¥960)

Arr. Time	Flight No.	Departure	Yonago Airport	JR Matsue Station
8:20	811	Tokyo	8:30	9:15
11:30	813	Tokyo	11:40	12:25
15:30	815	Tokyo	15:40	16:25
19:15	817	Tokyo	19:25	20:10
21:30	819	Tokyo	21:40	22:25

Matsue Station → Yonago Airport (JP¥960)

JR Matsue Station	Yonago Airport	Depart. Time	Flight No.	Destination
6:00	6:45	7:20	812	Tokyo
7:55	8:40	9:15	814	Tokyo
11:25	12:10	12:45	816	Tokyo
14:50	15:35	16:10	818	Tokyo
19:30	20:15	20:50	820	Tokyo

There are several ways to Izumo and Yonago airport. Our recommends for foreigners are as follows.

From Narita

Narita (NRT) -[Train] → Haneda (HND) -[Airline] → Izumo (IZO)

Narita (NRT) -[Train] → Haneda (HND) -[Airline] → Yonago (YGJ)

From Haneda

Haneda (HND) -[Airline] → Izumo (IZO)

Haneda (HND) -[Airline] → Yonago (YGJ)

From Kansai

Kansai (KIX) -[Bus] → Itami (ITM) -[Airline] → Izumo (IZO)

Trains

If you prefer to go to Matsue by train from Kansai International Airport (KIX), you may need to transfer at Shin-Osaka Station and Okayama Station. It may takes 4-5 hours from the Airport to Matsue.

From Kansai Airport

1. JR Airport Express, “Haruka”: Kansai (KIX) → Shin-Osaka Station
2. JR Shinkansen: Shin-Osaka → Okayama Station
3. JR Super Express, “Yakumo”: Okayama → Matsue Station

KUNIBIKI MESSE Floor map

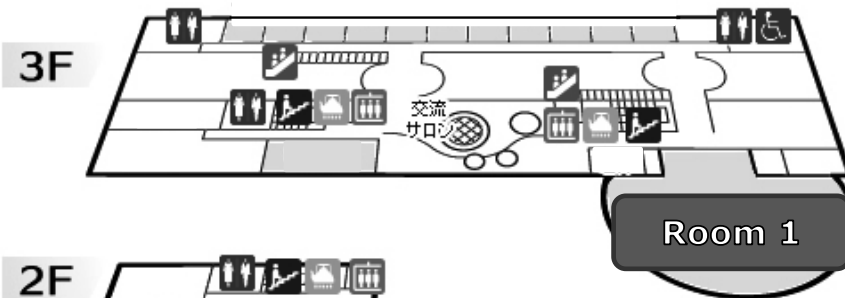
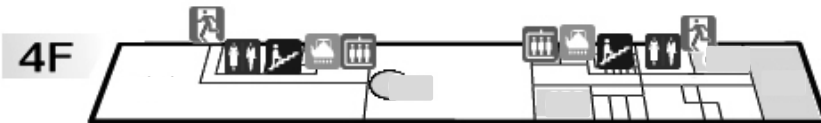
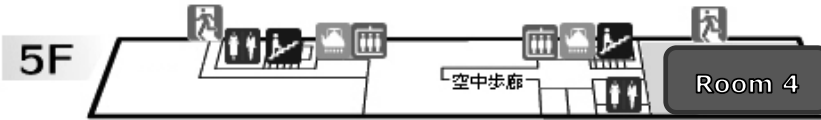

1F

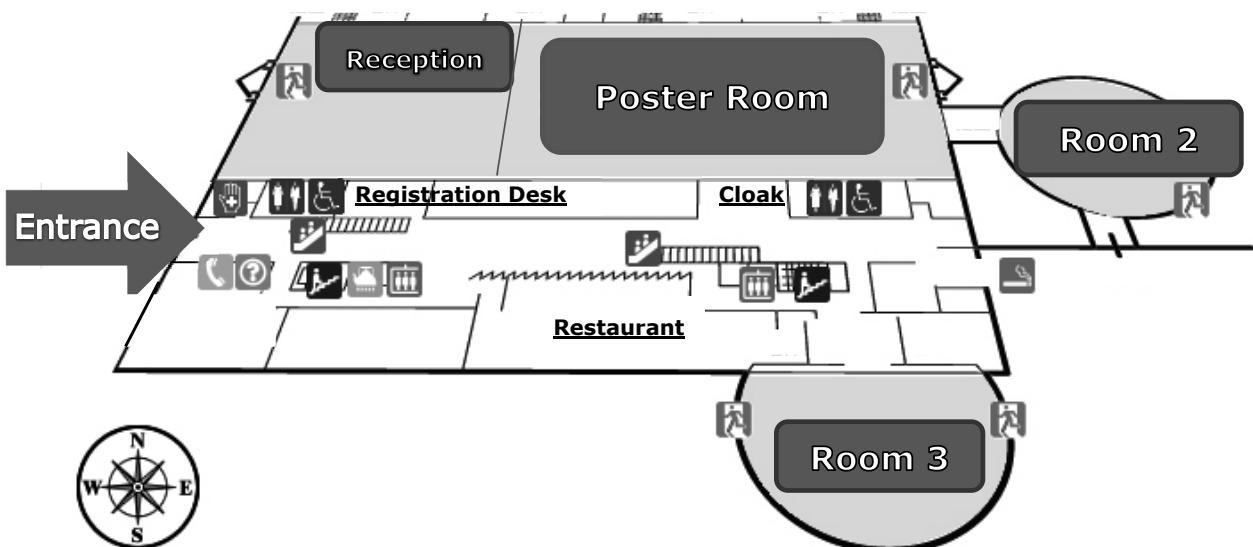

-  階段
Stairway
-  エレベータ
Elevator
-  トイレ
Rest room
-  救護室
First aid room
-  電話
Telephone
-  エスカレーター
Escalator
-  非常口
Emergency exit
-  給湯室
Hot water supply room
-  インフォメーション
Information booth
-  身障者用トイレ
Toilet for a handicapped person
-  喫煙場所
Smoking area

Program at a Glance

Day 0 (May 28(Tue))

	13:00 - 17:00	15:00 - 17:00	17:10 - 19:00
Room 2 (多目的ホール)		Satellite Workshops 1 : (in Japanese) Gametogenesis, fertilization and reproduction/Early embryogenesis/Cell differentiation/Cell-Cell/-Matrix interaction/Cell proliferation/Organogenesis	Satellite Workshops 2 : (in Japanese) Morphogenesis/Neural development and function/Regeneration/Technology, Theoretical approach
		15:30 - 18:30	18:40 - 20:45
Room 3 (小ホール)		Technical Workshop (in Japanese) Technical tips	Satellite symposium (in Japanese) “植物の逆襲—植物の形づくりの理論モデルと実験”
Room 4 (501)	DGD Editorial Meeting & JSDB Board Meeting		

Day 1 (May 29 (Wed)) OP=Oral Presentation, FT=Flash Talk

	8:30 - 10:10	10:25 - 11:50	12:10 - 13:10	13:25 - 15:50	16:25 - 17:35	17:45 - 19:00	19:00 - 20:00
Room 2 (多目的ホール)	OP 1 Neural development and function 1	OP 3 Neural development and function 2	Luncheon (Olympas Corporation) (in Japanese)	OP 5 Early embryogenesis 1 / Morphogenesis & Organogenesis 1	FT 1 Systems biology / Technology, Theoretical approach / Regulation of gene expression / EvoDevo	FT 3 Neural development and function / Organogenesis	
	OP 2 Early Cellular behavior and differentiation 1	OP 4 Early Cellular behavior and differentiation 2		OP 6 EvoDevo	FT 2 Cell proliferation / Cell biology / Cell death / Cell-Cell/-Matrix interaction / Cell differentiation / Regenerative medicine	FT 4 Stem cell / Epigenetics and Genomics / Others / Cell death / Aging	
Poster Room (大展示場)	Poster						Mixer with Poster
	Exhibition (Equipment & books)						
	Rest area						

Day 2 (May 30 (Thu)) OP=Oral Presentation, FT=Flash Talk

	8:30 - 10:10	10:25 - 11:50	12:10 - 13:10	13:20 - 14:50	15:10 - 16:50	17:00 - 19:00	19:00 - 21:00
Room 1 (国際会議場)	OP 7 Morphogenesis & Organogenesis 2	OP 10 Morphogenesis & Organogenesis 3	General assembly	Plenary Lecture	FT 5 Myogenesis / Early embryogen- esis		
Room 2 (多目的ホール)	OP 8 Cell biology	OP 11 Neural develop- ment and function 3 / Aging / Tech- nology, Theoretic- al approach			FT 6 Morphogenesis		
Room 3 (小ホール)	OP 9 Regulation of gene expression	OP 12 Early embryogen- esis 2			FT 7 Gametogenesis, fertilization and reproduction / Sex determination / Regeneration		
Poster Room (大展示場)	Poster			Poster Discussion			
	Exhibition (Equipment & books)						
	Rest area						Reception

Day 3 (May 31 (Fri)) OP=Oral Presentation, FT=Flash Talk

	8:30 - 10:10	10:25 - 11:50	12:10 - 13:10	13:30 - 15:30
Room 1 (国際会議場)	OP 13 Morphogenesis & Organogenesis 4	OP 16 Morphogenesis & Organogenesis 5 / Myogenesis	Luncheon Getting Published Well: Strategies for Success	Symposium 1 “Frontiers in Reproduction Research”
	OP 14 Regeneration	OP 17 Gametogenesis, fertilization and reproduction / Sex determination / Chronobiology	Luncheon Gender-equal Society (in Japanese)	Symposium 2 “The role of cell proliferation in development and regeneration”
	OP 15 Stem cell	OP 18 Regenerative medicine / Epigenetics and Genomics / Cell death		Symposium 3 “Advances in targeted genome editing”
Poster Room (大展示場)	Poster			
	Exhibition (Equipment & books)			
	Rest area			

General Information for Attendance

Venue

KUNIBIKI MESSE

1-2-1 Gakuen Minami, Matsue-city, Shimane 690-0826, Japan

Phone: +81-852-24-1111 Fax: +81-852-22-9219

URL: <http://www.kunibikimesse.jp/14.html>

Official Language

English will be the official conference language, and no simultaneous translation will be provided. The Satellite Workshops and Technical workshop and Satellite symposium will be held in Japanese.

Registrations

Advanced Registration is no longer available. Please register at the conference venue. (On-site registration is available throughout the conference period.)

Registration Fee (On-site) (JPY)

General JSDB/ISDB/APDBN members: ¥10,000 (early ¥8,000)

Student JSDB/ISDB/APDBN members: ¥5,000 (early ¥4,000)

General Non-members: ¥10,000 (early ¥9,000)

Student Non-members: ¥6,000 (early ¥5,000)

General Non-members (Residing overseas): ¥2,000 (early ¥0)

Student Non-members (Residing overseas): ¥1,000 (early ¥0)

*Registration includes access to all scientific sessions and exhibits.

*Students should provide the name and affiliation of their supervisor.

JSDB General Assembly

May 30 (Thursday), 12:15-13:10, Room 1

Payment

All payment must be made in Japanese yen, by credit card or by bank draft, payable to “The 46th Annual Meeting of the JSDB”. Please send payment with the completed registration form to the secretariat. No checks or money orders will be accepted. All bank charges are to be borne by the remitter.

Name Tags

Name tags will be sent to advance registrants, or will be provided at the time of registration. Participants are requested to wear their name tags at all times during the conference.

Lunch

Lunch boxes are available (¥1,000). At the luncheon seminar, a limited number of free lunch boxes will be provided by sponsor.

Refreshments and Internet Access

Wireless Internet connections are available at Poster Room.

The details of connecting methods will be presented at the reception desk.

DGD Editorial Meeting & JSDB Board Meeting

May 28 (Tue) 13:00-17:00, KUNIBIKI Messe Room 4

Reception

May 30 (Thu) 19:00-21:00

KUNIBIKI MESSE Poster room

Reception fee (On-site) (JPY)

General JSDB members: ¥6,000 (early ¥5,000)

Student JSDB members: ¥3,000 (early ¥4,000)

General non-members: ¥6,000 (early ¥5,000)

Student non-members: ¥3,000 (early ¥4,000)

General Non-members (Residing overseas): ¥6,000 (early ¥5,000)

Student Non-members (Residing overseas): ¥3,000 (early ¥4,000)

Luncheon Seminar

オリンパス株式会社 ランチョンセミナー

=Luncheon Seminar by Olympus Corporation.=

May 29 (Wed) 12:10-13:10, Room 2

Getting Published Well: Strategies for Success

Dr. Gary C. Schoenwolf (University of Utah School of Medicine)

May 31 (Fri) 12:10-13:10, Room 1

The 46th annual meeting for the JSDB cosponsored by the APDBN

オリンパス株式会社 ランチョンセミナー
=**Luncheon Seminar by Olympus Corporation.**=
May 29 (Tue) 12:10-13:10, Room 2

タイトル：「全能性幹細胞はどのように制御されているのか？」

講演者：阿形 清和先生（京都大学大学院理学研究科 生物科学専攻 生物物理学教室）

Stevens の EC 細胞株の樹立から始まった全能性幹細胞（私は“多能性”ではなく日本語として生殖細胞を含む全ての細胞種に分化できる意味で“全能性”を使う）の研究は、ES 細胞の樹立と iPS 細胞の創出の 2 つがノーベル賞に輝いたことで、広く一般の人にも知られるところとなった。われわれの世代は、漫画ブラックジャックのピノコの登場で全能性幹細胞を知り、そしてプラナリアの再生能力に全能性幹細胞の威力を学んだ。そして、プラナリアから全能性幹細胞の制御の仕方を知ることができれば、ブラックジャックの手を借りなくてもピノコが作れるはずだと…。そんな中、昨年のオリンパスのランチョン・セミナーでは、理研の笹井芳樹氏が全能性幹細胞から眼を作るところをライブイメージでみせて多くの聴衆を魅了した。今や、ブラックジャック笹井と呼んだ方が良いのかもしれない。今回のランチョン・セミナーでは、私がこの 20 年間にプラナリアから学んだ全能性幹細胞の扱い方についてお話ししたい。どうやったらピノコが作れるのか、私なりの全能性幹細胞観を伝えられればと思う。

OLYMPUS®

Your Vision, Our Future

第 46 回日本発生生物学会年会 保育室のご案内

保育室の利用を希望される方は、以下の規定を御確認の上、所定の手続き方法に従って日本語でお申込ください。なお保育士は英語を話しません。

託児時間	5月29日(水) 8:00～20:00 5月30日(木) 8:00～19:00 5月31日(金) 8:00～16:00 (*原則としてお子様の昼食は、保護者にご用意いただき、一緒におとりいただくこととなります。)
対象年齢	生後3ヶ月から12歳まで(大会参加者のお子様に限る)
託児場所	※セキュリティ確保の為、お申込者のみにご案内致します。
託児形態	託児の会へ保育士派遣を依頼します。
委託先	ちゅうりっぷ託児の会
託児料	500円/時間/お子さま1名(1時間未満は切上げ) 保育料のお支払いは、お子様をお預けの際にお願いします。 *申込みによりシッターが派遣されますので、当日のキャンセルや、実際の利用時間が申込時間よりも短くなった場合は、申込時の保育料のお支払いをお願いします。また、利用時間をやむを得ず延長された場合には、延長分のお支払いをお願いします。
申込み先	「利用規約(PDF94KB)」を確認のうえ、必要事項を記入した「申込書(PDF84KB)」をFAXまたはEメールにてお申し込みください。 1. 後日、詳細を記載しました「受領確認書」をお申し込み頂いた方法で返信します。 お申し込み後一週間以内に受領確認書が届かない場合には、下記の「申し込み先・お問い合わせ先」まで必ずお問い合わせください。 ※ 保育室の場所は、受領確認書に記載させていただきます。 ※ 電話での受付は 078-306-3072 (平日 9:00～17:00) ■申し込み先・お問い合わせ先 日本発生生物学会 事務局 担当: 桃津 FAX: 078-306-3072 E-mail: jsdb2013@jsdb.jp TEL: 078-306-3072 (平日 9:00～17:00)
申込締切	<u>2013年5月8日(水) 17時00分</u> ただし、定員になり次第締め切らせて頂きますのでお早めにお申込み下さい。
不測の事故に対応するために、ちゅうりっぷ託児の会が保険に加入しており、保険適用範囲で補償いたします。また第46回日本発生生物学会年会は、いかなる事故の責任も負わないことを申し添えます。	

Instructions for Presentations

大会発表についてのご注意

Oral presentations

We generally recommend that speakers use their own PCs for their presentations. Please come to your session room at least **30 min** prior to the beginning and connect your PC to a PC switcher. Alternatively, you can also use organizer-provided PCs in the conference rooms, but we do not guarantee device compatibility for each file. Although we can accept data from a USB flash drive or a CD-ROM, it is better to bring your data in at least two different methods. Slide projectors or overhead projectors will not be available.

Oral presentation: **8 minutes** for presentation and **4 minutes** for discussion.

Flash Talk: **4 minutes** presentation only.

Satellite Workshops: **10 minutes** presentation including discussion.

Attention: Personal computer information

The operating systems of the computer at the meeting venue are Windows 7 and Mac OS X 10.6.

Windows format files:

- Please copy your data onto a USB flash drive or a CD-ROM (Windows format).
- The system can support Windows PowerPoint 2003, 2007, and 2010.
- To avoid undesired changes of the slide layouts, we recommend using the following fonts: MS Gothic, MS Mincho, Times New Roman, or Century.

Macintosh format files:

- Please copy your data onto a USB flash drive or CD-ROM (Macintosh format).
- The system can support Macintosh PowerPoint 2004, 2008, and 2011; and Keynote 3, 4, and 5.
- Please use standard fonts installed in the program.
- If your presentation includes movies, please confirm beforehand that they can run properly on another computer. We recommend bringing your own computer to the venue as a backup.

* If your presentation includes movies, please confirm beforehand that they can run properly on another computer, or use your own PC.

For using your own PC:

- We accept Windows (Windows XP or later) or Macintosh (Mac OSX or later) PCs.
- You can use PowerPoint (Windows, Mac) or Keynote (Mac) for presentation.
- Make sure to bring any necessary electrical adaptors and connectors for your computer.
- The meeting venue will provide a Mini D-sub15 pin cable for connecting to PC switchers. Macintosh and certain kinds of Windows computers require an appropriate connector to fit a Mini D-sub15 pin plug.
- Electric power in Matsue is provided at 100 V, 60 Hz.

- In case your computer does not work, please bring your backup files on a USB flash drive or a CD-ROM.

Poster Presentations

Poster board size: 1,200 mm (width) × 2,100 mm (height)

- ✧ Please leave a 150 mm × 150 mm blank space at the top left corner for the organizing committee to indicate your poster number.
- ✧ During your assigned poster presentation time, please stay (or stand) in the vicinity of your poster for explanation.
- ✧ Best Presentation Awards will be given for several student presenters. Award winners will be selected using the web voting system by capable participants of the meeting, and will be announced after the meeting.

Poster:

Mounting: 8:00 - 13:00 on 29 May

Discussion: 17:00 - 19:00 on 30 May

17:00 -18:00 for even number posters

18:00 - 19:00 for odd number posters

Removal: 8:00 - 13:00 on 31 May

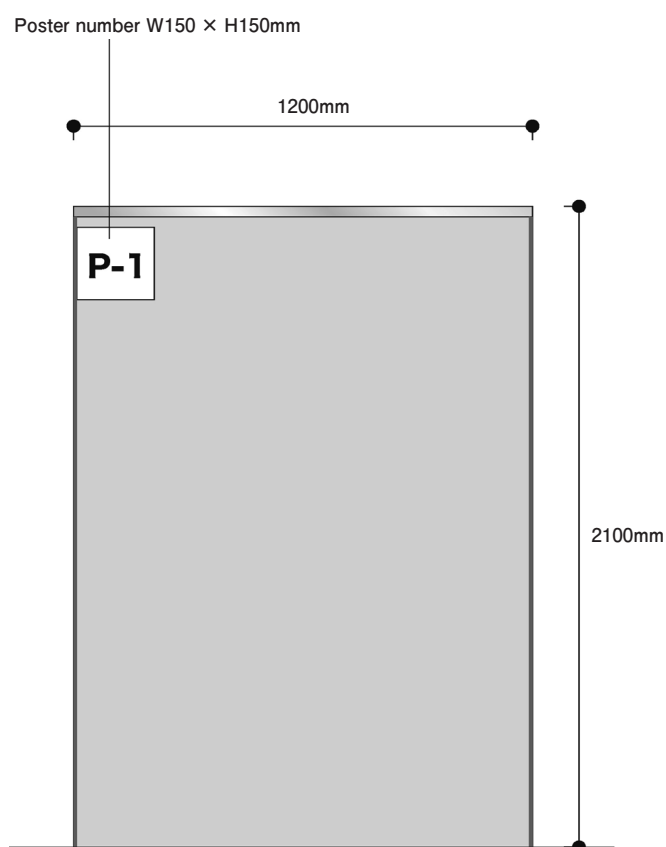

Chairpersons

All chairpersons are required to come to their assigned session rooms at least **30 minutes** prior to the start of the session they will chair.